

**Proposed Project at Mouza-Baderaipur, J.L. No-34,
Plot No-168, Premises No-176/14/168, Raipur Road,
Ward No-96, Borough-X, under Kolkata Municipal
Corporation, P.S.-Jadavpur, Kolkata-700092**

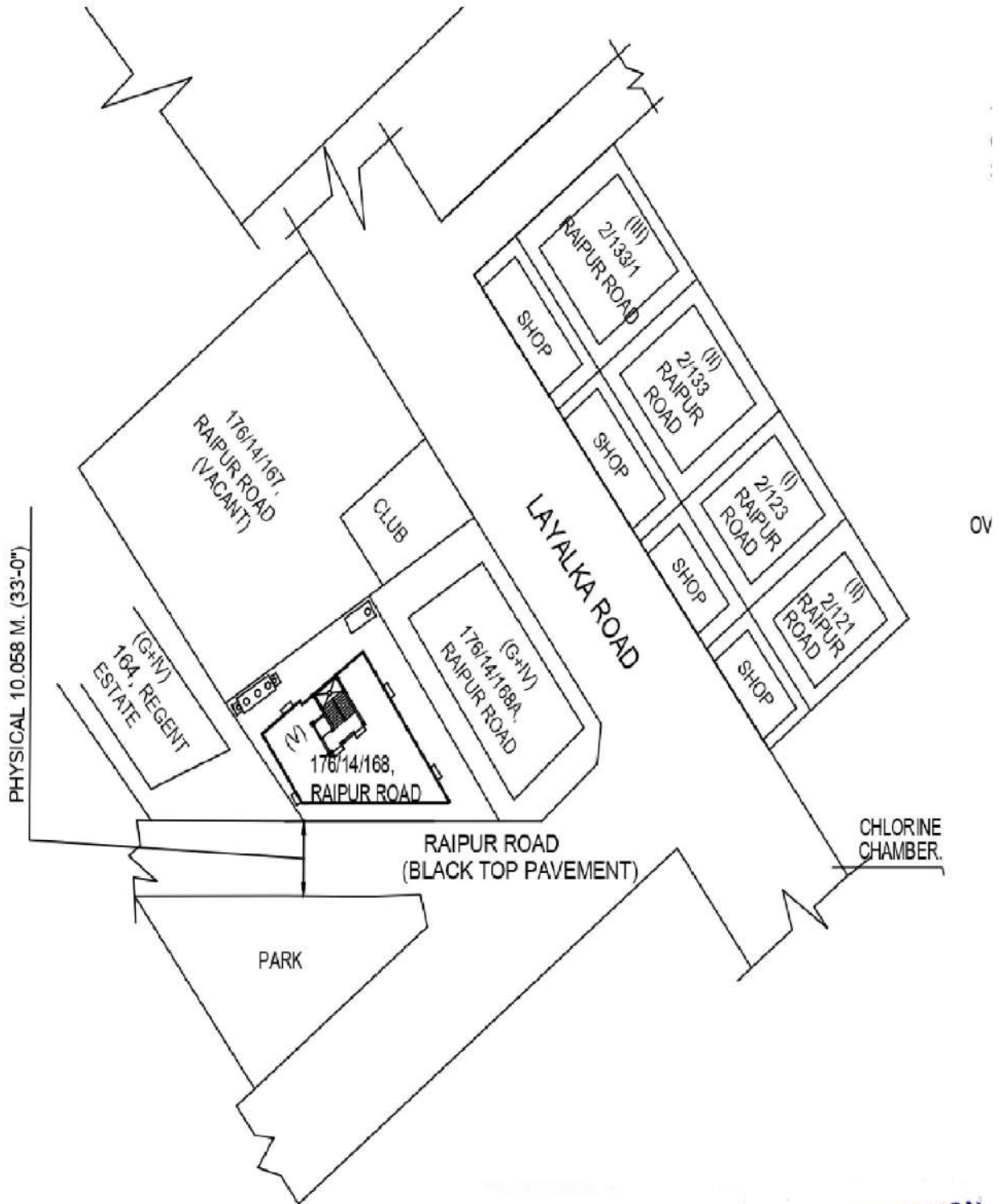

LATITUDE : 22.485499
LONGITUDE : 88.359126

For ESQUIRE CONSTRUCTION
K. Bhattacharya
Partner

SIGNATURE OF OWNER